

150 lb. SLIP-ON PLATE FLANGES - FOR PIPE

- OD AND DRILLING for 1/2" through 24" pipe size's per ASME / ANSI B16.5-1996 Class 150
- OD AND DRILLING for 30" & 36" pipe size per ASME / ANSI B16.1-1989 Class 125
- Tolerances: See chart (page 14)

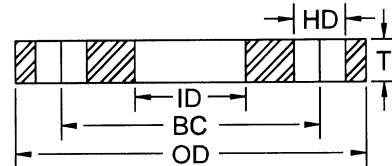

| NOMINAL PIPE SIZE | THICKNESS (T) | OUTSIDE DIA. (OD) | INSIDE DIA. (ID) | NUMBER OF HOLES | HOLE DIA. (HD) | BOLT CIRCLE (BC) | SHIPPING WEIGHT IN POUNDS |
|-------------------|---------------|-------------------|------------------|-----------------|----------------|------------------|---------------------------|
| 1/2 | .500 | 3.50 | .88 | 4 | .62 | 2.38 | 1.17 |
| 3/4 | .500 | 3.88 | 1.09 | 4 | .62 | 2.75 | 1.45 |
| 1 | .500 | 4.25 | 1.36 | 4 | .62 | 3.12 | 1.73 |
| 1 1/4 | .500 | 4.62 | 1.70 | 4 | .62 | 3.50 | 2.00 |
| 1 1/2 | .500 | 5.00 | 1.95 | 4 | .62 | 3.88 | 2.32 |
| 2 | .500 | 6.00 | 2.44 | 4 | .75 | 4.75 | 3.28 |
| 2 1/2 | .500 | 7.00 | 2.94 | 4 | .75 | 5.50 | 4.50 |
| 3 | .500 | 7.50 | 3.57 | 4 | .75 | 6.00 | 4.88 |
| 3 1/2 | .500 | 8.50 | 4.07 | 8 | .75 | 7.00 | 6.04 |
| 4 | .500 | 9.00 | 4.57 | 8 | .75 | 7.50 | 6.57 |
| 5 | .500 | 10.00 | 5.66 | 8 | .88 | 8.50 | 7.31 |
| 6 | .500 | 11.00 | 6.72 | 8 | .88 | 9.50 | 8.24 |
| 8 | .500 | 13.50 | 8.72 | 8 | .88 | 11.75 | 11.83 |
| 10 | .625 | 16.00 | 10.88 | 12 | 1.00 | 14.25 | 18.39 |
| 12 | .625 | 19.00 | 12.88 | 12 | 1.00 | 17.00 | 26.80 |
| 14 | .625 | 21.00 | 14.14 | 12 | 1.12 | 18.75 | 33.05 |
| 16 | .750 | 23.50 | 16.16 | 16 | 1.12 | 21.25 | 47.45 |
| 18 | .750 | 25.00 | 18.18 | 16 | 1.25 | 22.75 | 47.21 |
| 20 | 1.000 | 27.50 | 20.20 | 20 | 1.25 | 25.00 | 73.76 |
| 24 | 1.000 | 32.00 | 24.25 | 20 | 1.38 | 29.50 | 92.64 |
| 30 | 1.000 | 38.75 | 30.25 | 28 | 1.38 | 36.00 | 124.16 |
| 36 | 1.250 | 46.00 | 36.25 | 32 | 1.62 | 42.75 | 207.40 |

For 38" through 48" use 1.250 for thickness • For 50" through 72" use 1.500 for thickness

Notes: This table is intended for estimating purposes only. Applications vary, confirm all dimensions with your engineering department prior to ordering. Refer to ASME B16.5-1996 and B-16.1-1989 standard for complete engineering and applications information. All dimensions are in inches unless otherwise noted. Inside diameter and thickness dimensions are application specific. Recommended bolts are 1/8" smaller in diameter than the bolt hole diameters shown.